

Meet the Windsor

SHOW HOME IN HOMESTEAD
119 HOMESTEAD DRIVE NE CALGARY, ALBERTA



1753 SQ. FT.

3 

2.5 

MAIN FLOOR 867 SQ.FT.

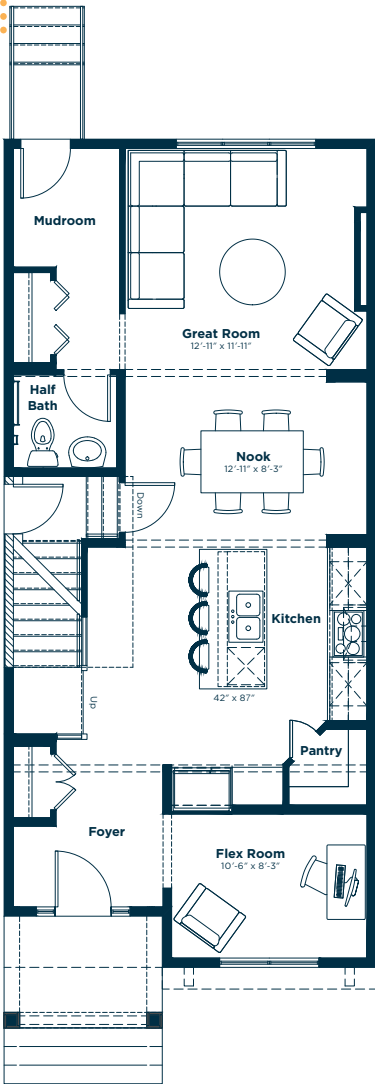

SECOND FLOOR 886 SQ.FT.

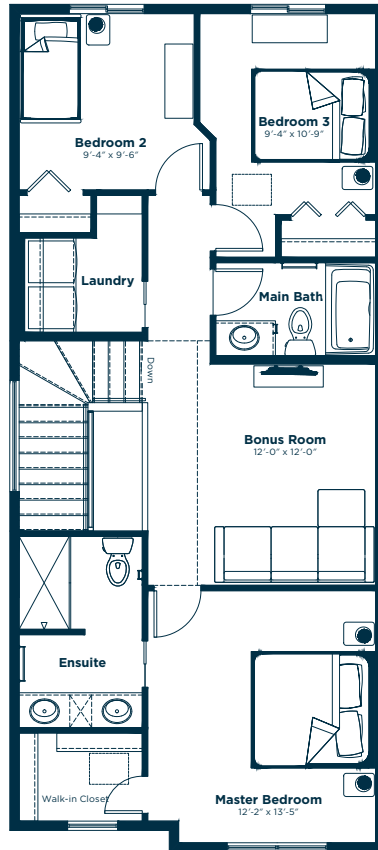

BASEMENT LEVEL 615 SQ.FT.

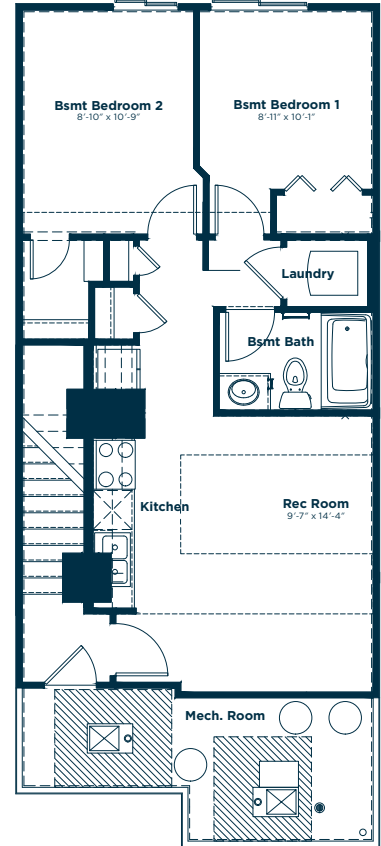

**EXCEL
HOMES**

Simplifying your journey home.

Meet the Windsor

SHOW HOME IN HOMESTEAD

Options and upgrades.

MAIN FLOOR

- 9' Main Floor Ceiling
- Paint: Summit
- LVP Flooring: Miss Sunshine
- Carpet: Quartz Light

KITCHEN

- Increased Island Size
- Additional Potlights
- Level 3 Fridge
- Level 2 Gas Range
- Cabinets: Apres Ski
- Engineered Stone Countertops: Carbon
- Backsplash: Stella

GREAT ROOM

- Additional Pot Lights
- Full Height Electric Fireplace
- Fireplace Tile: Kronos - Black

SECOND FLOOR:

- Vaulted Bonus Room
- Additional Potlights to Bonus Room
- Wall Tile: Kronos - Black

ENSUITE

- Dual Sinks
- Upgraded Tubshower
- Additional Bank of Drawers
- Engineered Stone Countertops: Carbon
- Floor Tile: Kronos - Black

LAUNDRY

- Upgraded Counter Size
- Level 3 Washer and Dryer
- Engineered Stone Countertops: Bright White
- Floor Tile: Kronos - Black

EXTERIOR

- Pressure Treated Rear Deck
- Gas Line for BBQ
- Exterior Side Entry to Basement

BASEMENT

- Developed Two Bedroom Suite
- Level 2 Washer and Dryer
- Cabinets: Apres Ski
- Engineered Stone Countertops: Bright White
- Paint: Summit
- Bathroom LVT Flooring: Dark Victory
- Carpet: Quartz Light
- Backsplash: Arctic White

OTHER

- NEW Selections - Elevation Y
- Knockdown Ceiling Finish
- Level 1 Finishing Package
- Level 2 Lighting Package
- Level 1 Plumbing Package
- Paint Grade Railing and Spindles
- Audio Zone Systems
- Air Conditioning
- Security Pre-wiring
- Show Home Landscaping
- Please see your Area Manager for the additional upgrades included in your home

For more information.

Katie Schock
HOMESTEAD LANED AREA MANAGER

403-475-5817
HOMESTEAD@EXCELHOMES.CA

EXCELHOMES.CA