

Meet the Bentley

SHOW HOME IN EDMONTON
8907 ELVES LOOP NW EDMONTON, ALBERTA



DUPLEX
COLLECTION

1565

SQ.
FT.

3



2.5

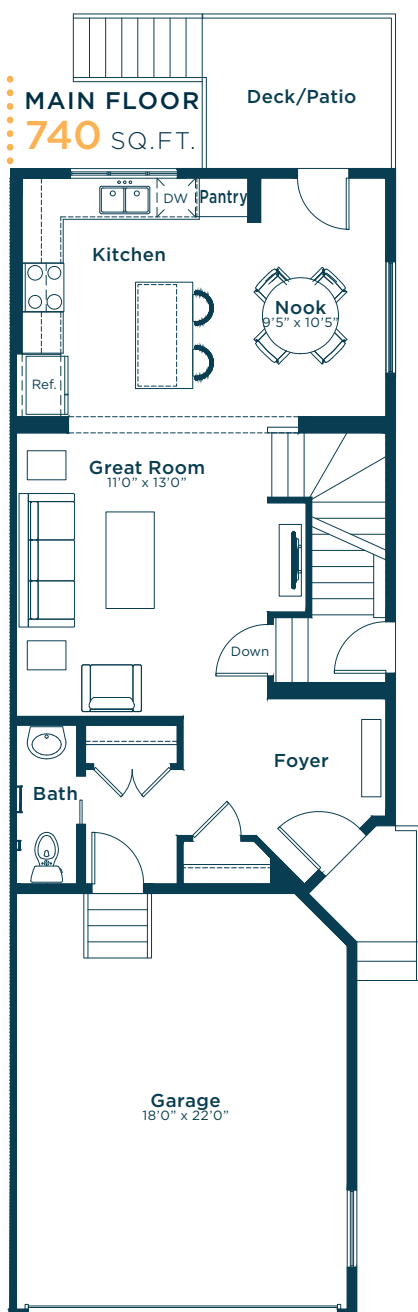

SECOND FLOOR
825 SQ.FT.

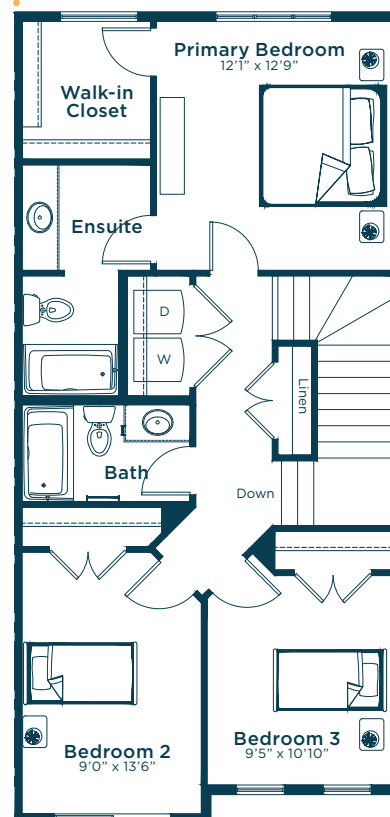

**EXCEL
HOMES**

Simplifying your journey home.



Meet the Bentley

SHOW HOME IN EDMONTON

Options and upgrades.

MAIN FLOOR

- Cabinets: Cloud White
- Quartz Countertops: White Rock
- Backsplash: Eksa Island White Matte
- LVP: Borque

SECOND FLOOR

- Cabinets: Cloud White
- Quartz Countertops: White Rock
- Backsplash: Eksa Island White Matte
- Carpet: Ecru

EXTERIOR

- Rear Pressure Treated Deck
- Black Window Frames to Rear Windows

BASEMENT

- 9' Ceilings
- Basement Entry to Interior Stairwell

OTHER

- Bentley Elevation MF2
- Paint: Designer Grey
- Audio Zone Systems
- Air Conditioning
- Security Pre-wiring
- Show Home Landscaping
- Please see your Area Manager for the additional upgrades included in your home



For more
information.

Anabela daPonte-Cordeiro
EDMONTON AREA MANAGER

780-756-8515
EDMONTON@EXCElhOMES.CA



EXCElhOMES.CA

This floorplan represents one version of this home and measurements are approximate. The square footage, measurements and layout may vary based on the elevation and/or lot. All elevations shown are artist's concept only and will vary by community. The builder reserves the right to make modifications or substitutions should they be necessary. All plans, options, dimensions, specifications, materials and drawings are subject to change without notice. E.&O.E.