

# Meet the Sienna

QUICK POSSESSION HOME IN EDMONTON  
472 EDMONTON DRIVE NW EDMONTON, ALBERTA



LANE COLLECTION

1636 SQ. FT.

4

3



## This home's interior palette is the following:



LVP: Montreal

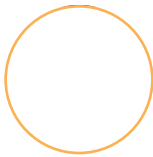

Cabinets: True White

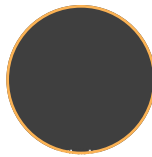

Island Cabinet: Charcoal



Backsplash: Dark Grey Glossy

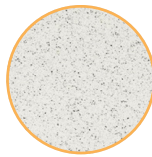

Quartz Countertops: Flint



Carpet: Walking Trail



Paint: Summit

## This home features the following:

- Main floor bedroom and full bathroom
- Level 1 kitchen
- Level 2 lighting
- Exterior side entry to basement
- 1-bedroom basement suite rough-in

## Standard features:

- BUILT GREEN® certified home
- Stainless steel appliances
- Thermally fused laminate cabinets
- Luxury vinyl plank throughout entire main floor and second floor wet areas
- Please see your Area Manager for the complete list of standard features

## You can purchase this home for:

\$

including home, lot and GST

## Home availability:



## For more information:



**Anabela daPonte-Cordeiro**  
EDGEMONT AREA MANAGER

T: 780-278-9143  
E: edgemont@excelhomes.ca



Simplifying your journey home.

# Meet the Sienna

QUICK POSSESSION HOME IN EDMONTON 472 EDMONTON DRIVE NW

## Floor plans

• MAIN FLOOR  
• 819 SQ.FT.

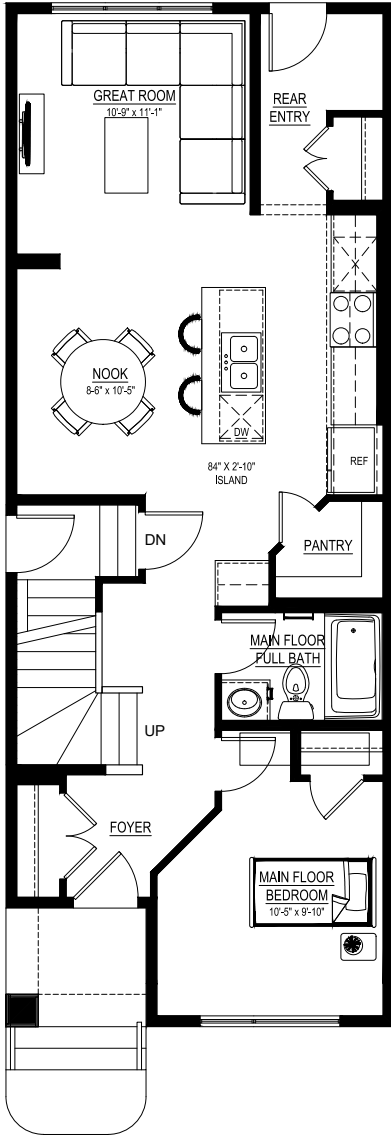

• SECOND FLOOR  
• 817 SQ.FT.

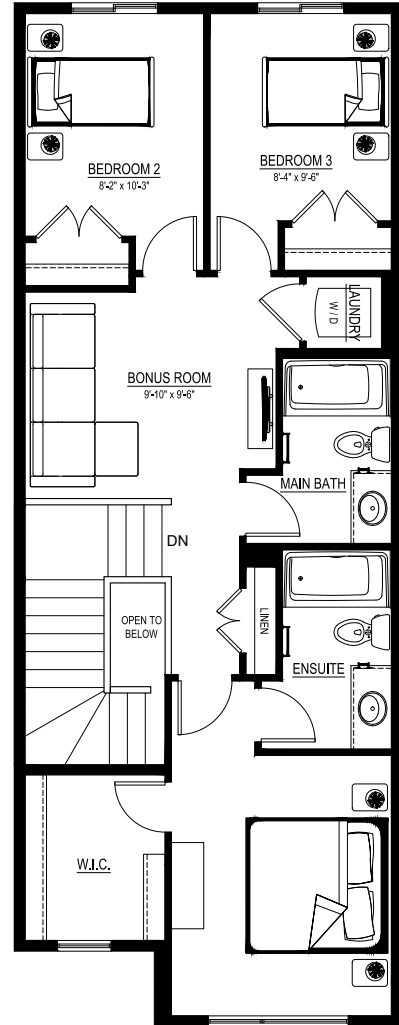

For more information.

Anabela daPonte-Cordeiro  
EDMONTON AREA MANAGER

780-278-9143  
EDMONTON@EXCELHOMES.CA

EXCELHOMES.CA