

Meet the Sienna



QUICK POSSESSION HOME IN EDMONTON
470 EDMONTON DRIVE NW EDMONTON, ALBERTA



LANED COLLECTION

1636 SQ. FT.

4

3

This home's interior palette is the following:



LVP: Winnipeg



Cabinets: Free Spirit



Backsplash: Glossy White



Quartz Countertops: White Rock



Carpet: Weathered



Paint: Smokey

This home features the following:

- Level 1 kitchen
- Exterior side entry to basement
- Basement suite rough-in (one bedroom)
- Bedroom on main floor with full bathroom

Standard features:

- BUILT GREEN® certified home
- Stainless steel appliances
- Thermally fused laminate cabinets
- Luxury vinyl plank throughout entire main floor and second floor wet areas
- Please see your Area Manager for the complete list of standard features

You can purchase this home for:

\$

including home, lot and GST

Home availability:



For more information:



Anabela daPonte-Cordeiro
EDGEMONT AREA MANAGER

T: 780-278-9143

E: edgemont@excelhomes.ca



Simplifying your journey home.

Meet the Bentley

QUICK POSSESSION HOME IN EDMONTON 470 EDMONTON DRIVE NW

Floor plans

MAIN FLOOR
819 SQ.FT.

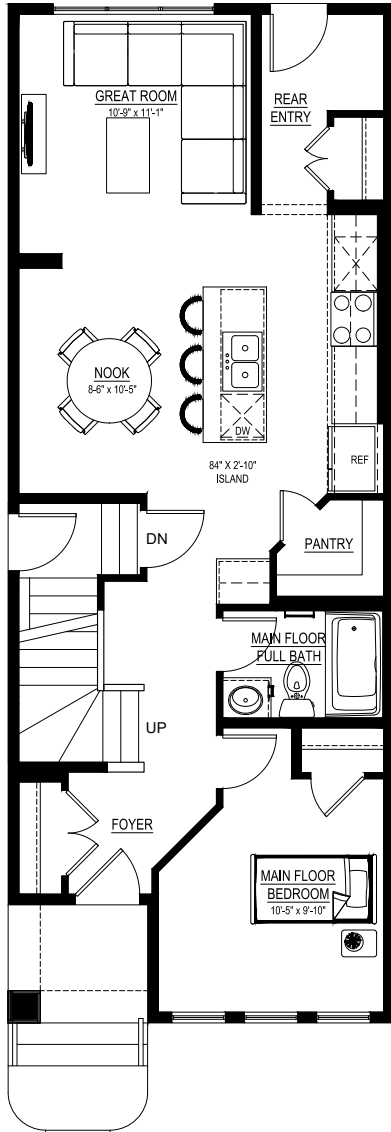

SECOND FLOOR
817 SQ.FT.

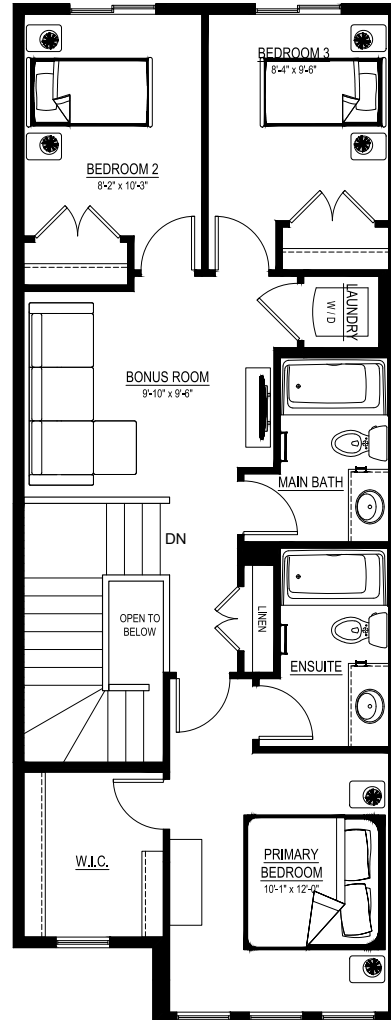

For more information.

Anabela daPonte-Cordeiro
EDMONTON AREA MANAGER

780-278-9143
EDMONTON@EXCELHOMES.CA

EXCELHOMES.CA