

Meet the Lakeside

QUICK POSSESSION HOME IN VITA CRYSTALLINA
7388 182 AVENUE NW EDMONTON, ALBERTA



FRONT GARAGE COLLECTION

1945 SQ. FT.

4 

3 



This home's interior palette is the following:



LVP: Arctic



Cabinets: Free Spirit

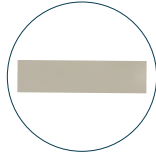

Backsplash: Fawn



Countertops: Halcyon



Carpet: Sand Martin

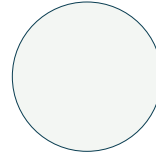

Paint: Summit

This home features the following:

- Level 1 kitchen upgrade complete with crown moulding, island extension, 42" upper cabinets, and one pots and pans drawer
- Main floor bedroom
- Full bath to main floor
- Level 1 pendant to kitchen island
- Large chandelier to stairwell
- Small chandelier to nook
- Dual sinks to ensuite
- Exterior side entry to basement

Standard features:

- BUILT GREEN® certified home
- Stainless steel appliances
- Thermally fused laminate cabinets
- Luxury vinyl plank throughout entire main floor and second floor wet areas
- Please see your Area Manager for the complete list of standard features

You can purchase this home for:

\$

including home, lot and GST

Home availability:



For more information:



Khush Sandhu
VITA CRYSTALLINA AREA MANAGER

T: 780-718-4869

E: vitacrystallina@excelhomes.ca



Simplifying your journey home.

Meet the Lakeside

QUICK POSSESSION HOME IN VITA CRYSTALLINA 7388 182 AVENUE NW

Floor plans

MAIN FLOOR
896 SQ.FT.

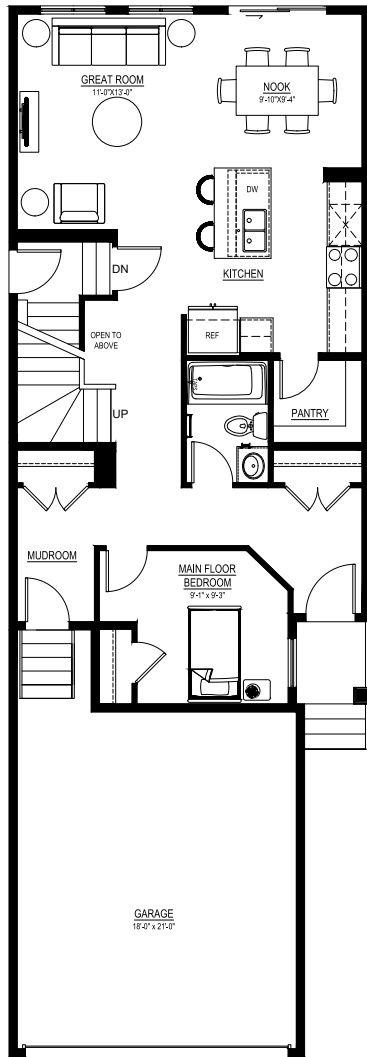

SECOND FLOOR
1049 SQ.FT.

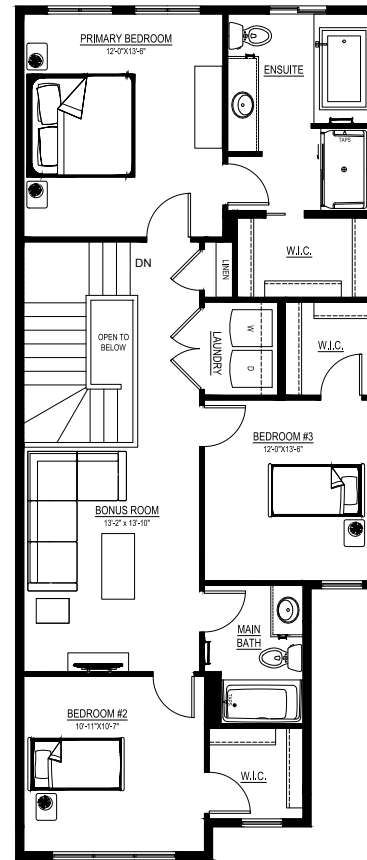

For more information.

Khush Sandhu
VITA CRYSTALLINA AREA MANAGER

780-718-4869
VITACRYSTALLINA@EXCELHOMES.CA

EXCELHOMES.CA

This floorplan represents one version of this home and measurements are approximate. The square footage, measurements and layout may vary based on the elevation and/or lot. All elevations shown are artist's concept only and will vary by community. The builder reserves the right to make modifications or substitutions should they be necessary. All plans, options, dimensions, specifications, materials and drawings are subject to change without notice. E.&O.E