







Meet the Lakeside

QUICK POSSESSION HOME IN THE ORCHARDS
5304 HAWTHORN CLOSE SW EDMONTON, ALBERTA

 FRONT GARAGE COLLECTION **1958** SQ. FT. **4**  **3** 

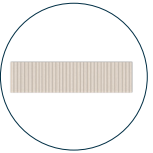

This home's interior palette is the following:

							
LVP: Focus	Cabinets: Gardenia	Kitchen Island Cabinets: Pewter Green	Kitchen Backsplash: Julian Murano Ivory	Ensuite & Bath Backsplash: Eksa Atlas White	Countertops: Miami White	Carpet: Sand Martin	Paint: Crystal

This home features the following:

- Level 1 kitchen upgrade complete with crown moulding, island extension, 42" upper cabinets, and one pots and pans drawer
- Level 1 ensuite upgrade complete with a soaker tub, standing shower with tile surround, dual sinks and an additional bank of drawers
- Main floor bedroom
- Full bath on main floor
- Upgrade tubshower to shower in main floor bath
- Level 2 matte black door handles
- Level 1 black pendant to kitchen island
- Raven black iron spindled railing
- Exterior side entry to basement

Standard features:

- BUILT GREEN® certified home
- Complete 6-piece ENERGY STAR® rated appliance package
- 1 1/4" quartz countertops throughout
- Luxury vinyl plank throughout entire main floor and second floor wet areas
- Full yard landscaping
- Please see your Area Manager for the complete list of standard features

You can purchase this home for:

\$

including home, lot and GST

Home availability:

For more information:



Amber Amritwar
THE ORCHARDS

T: 780-977-2739
E: theorchards@excelhomes.ca



..... Simplifying your journey home.

Meet the Lakeside

QUICK POSSESSION HOME IN THE ORCHARDS 5304 HAWTHORN CLOSE SW

Floor plans

• MAIN FLOOR
• 896 SQ.FT.

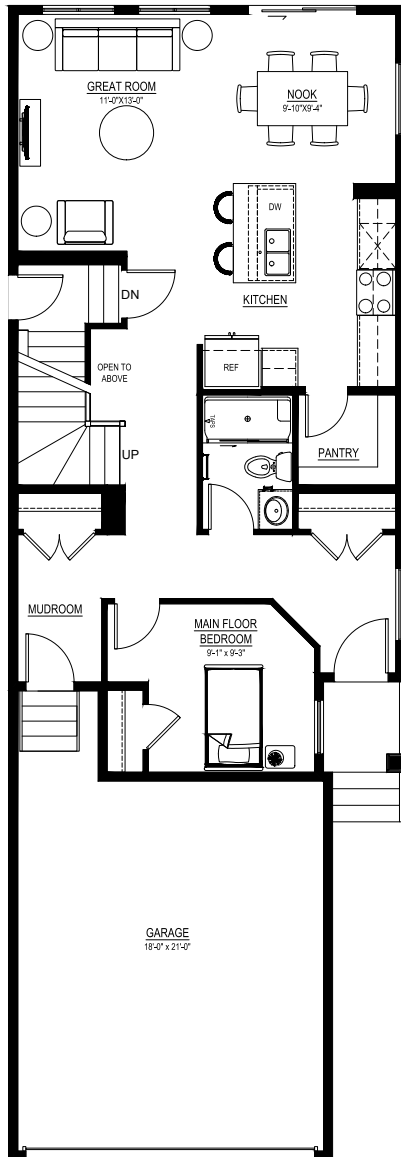

• SECOND FLOOR
• 1052 SQ.FT.

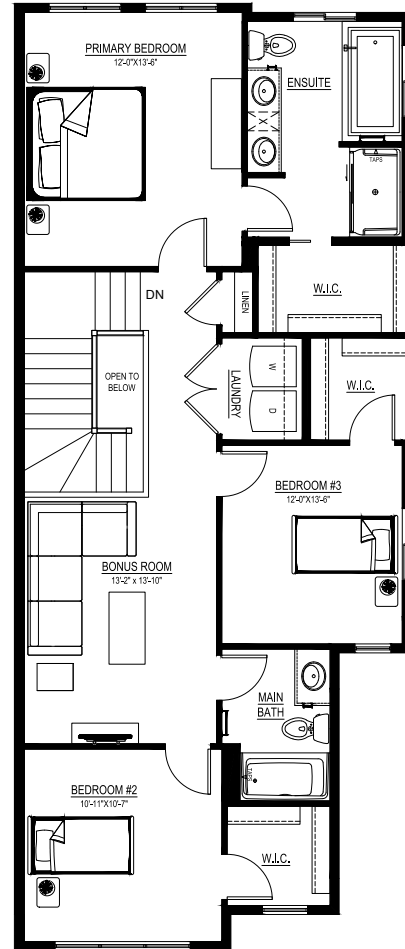

For more information.

Amber Amritwar
THE ORCHARDS AREA MANAGER

780-977-2739
THEORCHARDS@EXCELHOMES.CA

EXCELHOMES.CA