

Meet the Beckett

QUICK POSSESSION HOME IN THE ORCHARDS
5633 HAWTHORN WAY SW EDMONTON, ALBERTA



DUPLEX COLLECTION

1670 SQ. FT.

3

2.5



This home's interior palette is the following:



LVP: Arctic



Cabinets: Free Spirit



Backsplash: Eksa Atlas White

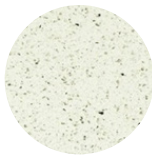

Countertops: Crystal Crescent



Carpet: Mountain Rocks

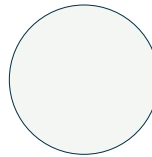

Paint: Summit

This home features the following:

- Exterior side entry to basement
- Kitchen upgrade level 1

Standard features:

- BUILT GREEN® certified home
- Complete 6-piece ENERGY STAR® rated appliance package
- 1 1/4" quartz countertops throughout
- Luxury vinyl plank throughout entire main floor and second floor wet areas
- Full yard landscaping
- Please see your Area Manager for the complete list of standard features

You can purchase this home for:

\$

including home, lot and GST

Home availability:



For more information:



Amber Amritwar
THE ORCHARDS

T: 780-977-2739

E: theorchards@excelhomes.ca



Simplifying your journey home.

Meet the Beckett

QUICK POSSESSION HOME IN THE ORCHARDS 5633 HAWTHORN WAY SW

Floor plans

MAIN FLOOR
735 SQ.FT.

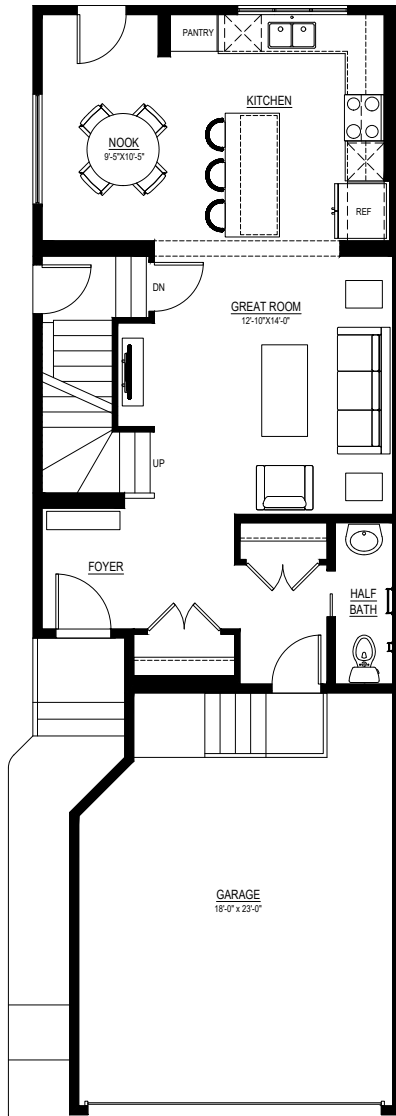

SECOND FLOOR
935 SQ.FT.

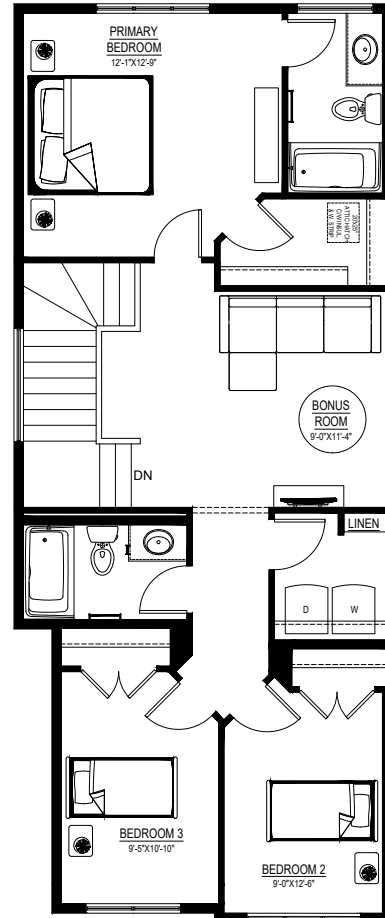

For more information.

Amber Amritwar
THE ORCHARDS AREA MANAGER

780-977-2739
THEORCHARDS@EXCELHOMES.CA

EXCELHOMES.CA

This floorplan represents one version of this home and measurements are approximate. The square footage, measurements and layout may vary based on the elevation and/or lot. All elevations shown are artist's concept only and will vary by community. The builder reserves the right to make modifications or substitutions should they be necessary. All plans, options, dimensions, specifications, materials and drawings are subject to change without notice. E.&O.E