

# Meet the Beckett



QUICK POSSESSION HOME IN ALCES  
714 22ND STREET SW EDMONTON, ALBERTA



DUPLEX  
COLLECTION

1670 SQ.  
FT.

3

2.5

## This home's interior palette is the following:



LVP:  
Arctic



Kitchen, Ensuite &  
Bath Cabinets:  
Free Spirit

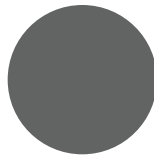

Kitchen Island  
Cabinets:  
Shadow

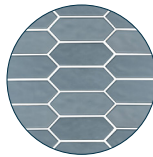

Kitchen  
Backsplash:  
Denim Picket

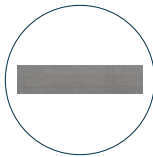

Ensuite & Bath  
Backsplash:  
Dark Grey

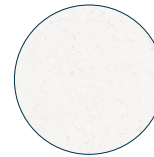

Countertops:  
Miami Vena

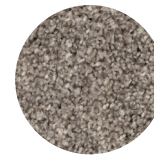

Carpet:  
Comet Grey

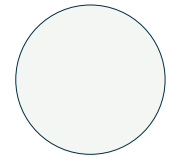

Paint:  
Summit

## This home features the following:

- Level 1 kitchen upgrade complete with crown moulding, island extension, 42" upper cabinets, and one pots and pans drawer
- Upgrade tubshower to shower in ensuite
- Level 1 brushed nickel pendant to island
- Level 1 small brushed nickel chandelier to nook
- Level 1 steel flush mount fixture
- Exterior side entry

## Standard features:

- BUILT GREEN® certified home
- Complete 6-piece ENERGY STAR® rated appliance package
- 1/4" quartz countertops throughout
- Luxury vinyl plank throughout entire main floor and second floor wet areas
- Full yard landscaping
- Please see your Area Manager for the complete list of standard features

## You can purchase this home for:

\$

including home, lot and GST

## Home availability:



## For more information:



**Sudip Punoria**  
ALCES AREA MANAGER

T: 780-709-8730  
E: [spunoria@excelhomes.ca](mailto:spunoria@excelhomes.ca)



..... Simplifying your journey home.

# Meet the Beckett

QUICK POSSESSION HOME IN ALCES 714 22ND STREET SW

## Floor plans

MAIN FLOOR  
735 SQ.FT.

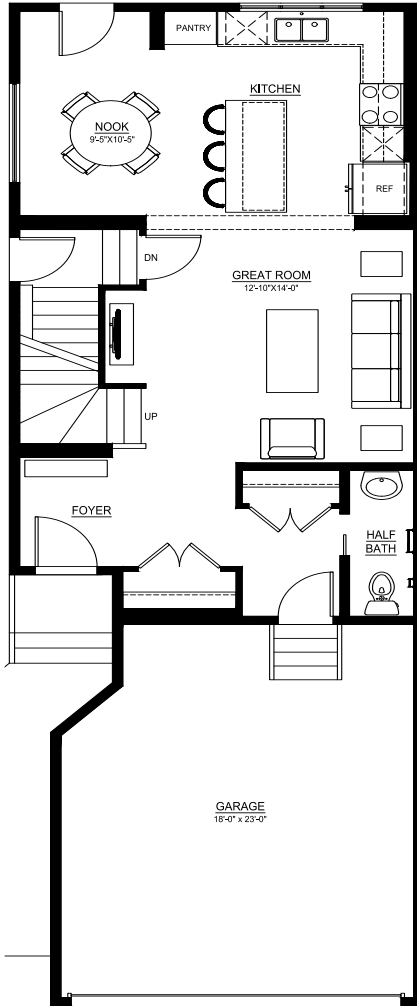

SECOND FLOOR  
935 SQ.FT.

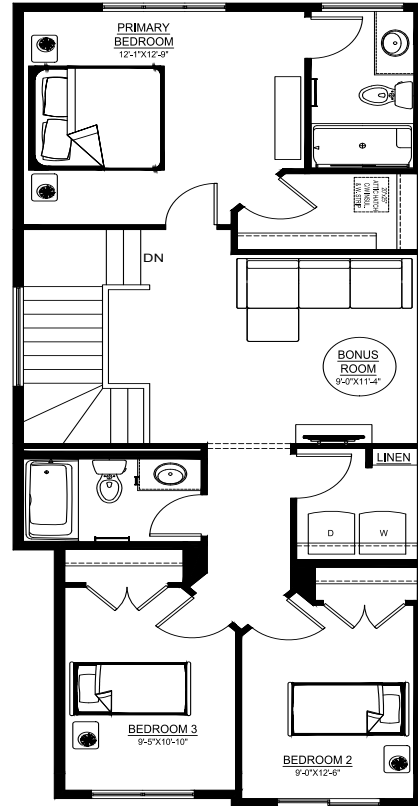

For more information.

**Sudip Punoria**  
ALCES AREA MANAGER

**780-709-8730**  
SPUNORIA@EXCELHOMES.CA

**EXCELHOMES.CA**

This floorplan represents one version of this home and measurements are approximate. The square footage, measurements and layout may vary based on the elevation and/or lot. All elevations shown are artist's concept only and will vary by community. The builder reserves the right to make modifications or substitutions should they be necessary. All plans, options, dimensions, specifications, materials and drawings are subject to change without notice. E.&O.E