

Meet the Beckett

QUICK POSSESSION HOME IN EDMONTON
114 EDMONTON WYND NW, EDMONTON, ALBERTA



DUPLEX
COLLECTION

1670 SQ.
FT.

3

2.5



This home's interior palette is the following:



LVP:
Arctic



Cabinets:
Chicory



Cabinets:
Ebony

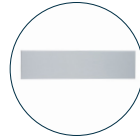

Backsplash:
White Matte



Countertops:
Halcyon



Carpet:
Sand Martin

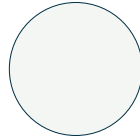

Paint:
Summit

This home features the following:

- Level 1 kitchen
- Exterior side entry
- Level 1 matte black pendant to kitchen island
- Level 1 matte black kitchen faucet

Standard features:

- BUILT GREEN® certified home
- Complete 6-piece ENERGY STAR® rated appliance package
- 1 1/4" quartz countertops throughout
- Luxury vinyl plank throughout entire main floor and second floor wet areas
- Full yard landscaping
- Please see your Area Manager for the complete list of standard features

You can purchase this home for:



including home, lot and GST

Home availability:



For more information:



Anabela daPonte-Cordeiro
EDGEMONT AREA MANAGER

T: 780-278-9143

E: edgemont@excelhomes.ca



Simplifying your journey home.

Meet the Beckett

QUICK POSSESSION HOME IN EDMONTON 114 EDMONTON WYND NW

Floor plans

• MAIN FLOOR
• 735 SQ.FT.

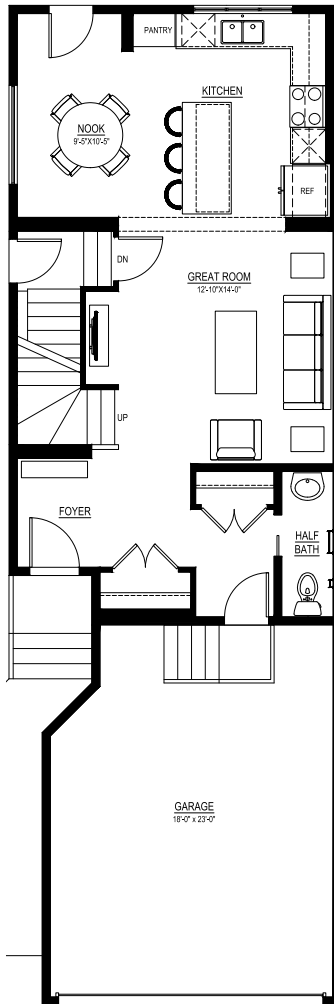

• SECOND FLOOR
• 935 SQ.FT.

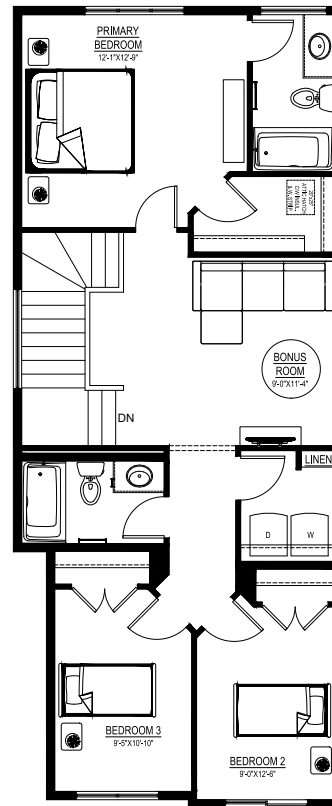

For more information.

Anabela daPonte-Cordeiro
EDMONTON AREA MANAGER

780-278-9143
EDMONTON@EXCELHOMES.CA

EXCELHOMES.CA

This floorplan represents one version of this home and measurements are approximate. The square footage, measurements and layout may vary based on the elevation and/or lot. All elevations shown are artist's concept only and will vary by community. The builder reserves the right to make modifications or substitutions should they be necessary. All plans, options, dimensions, specifications, materials and drawings are subject to change without notice. E.&O.E